

ALL-AROUND RELIABILITY

# TURBIN GLASS MIXER

AROUND-THE-CLOCK PRODUCTIVITY

## PROVES ITSELF FROM THE START

Non-stop operation is everything in glass manufacturing, and no component on the line is more important than your mixer. The Turbin from GlassMASTER is a rugged design tested in the harsh environment of glassmaking. Equipped with hardened, replaceable liners and paddles, it quickly and thoroughly blends dry materials with a unique "braiding" action. And its large capacity helps keep your plant running at peak efficiency. Shift after shift, batch after batch, Turbin is clearly the mixer of choice for glass production.

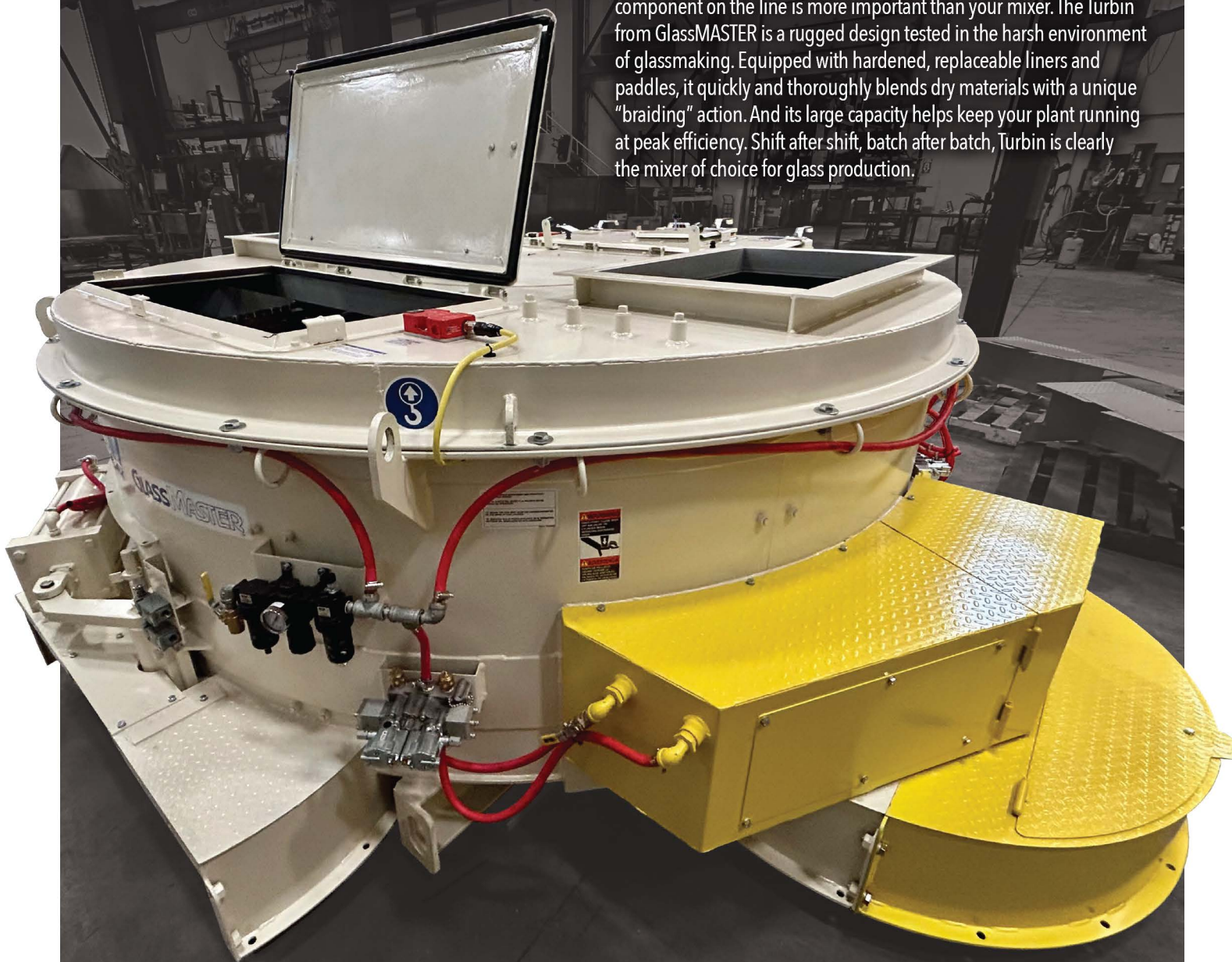

**GLASSMASTER®**

PROUDLY  
MADE IN  
AMERICA





# ANY MATERIALS, ANY GLASS, ANY APPLICATION

## TURBIN GLASS MIXER

### AMERICAN-MADE AND WORKFLOW READY.

Order the Turbin and have it on the job without delays. Our U.S. factory fulfills orders efficiently, offers an installation package, and backs mixers with full service and support. Plus, our warehouse stocks a complete inventory of parts and ships most orders within 24 hours.



#### STURDY CONSTRUCTION

All-welded steel tank mounted to channel frame with lifting lugs

#### LUBRICATION FOR MAXIMUM PERFORMANCE

Automatic lubrication keeps gears and seals lubricated at all times

#### WEAR PART PACKAGES AVAILABLE

Optional liner packages for special applications

#### EASY SERVICEABILITY

Motor located outside mixer for ease of service and cooler operation



# FEATURES KEEP YOUR OPERATION RUNNING SMOOTHLY



Heavy-duty mixing tank (shown with cover removed); center drive hub and enclosed gearbox



Optional MAXALLOY tank wall and floor liners; AR360 liners are standard



Cast Ni-Hard wall scrapers; optional MAXALLOY scrapers are available



Cast Ni-Hard mixing paddles; optional MAXALLOY paddles are available



Mixer interlock station with E-Stop, warning horn / strobe, and hour meter



Mixer transmission lube station with pump and filter



Mixer high-efficiency motor with protective dust shield



Solenoid valves with speed controls for automatic discharge door operation



Air filter/regulator/lubricator for all pneumatic cylinders and valves supplied



Discharge door position limit switches



Hinged access door limit switches



Hinged access doors for cleaning and part replacement



Hinged inspection door on mixer cover



Custom mixer batch inlets, venting ports, and water inlets



Mixer discharge door with guarding and round connection flange



## TURBIN GLASS MIXER SPECIFICATIONS

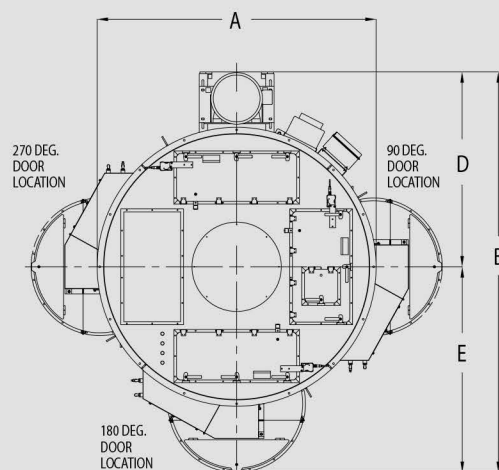

TOP VIEW

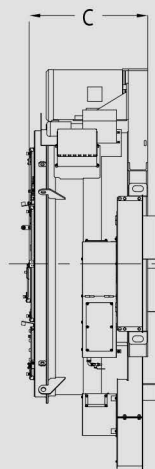

SIDE VIEW

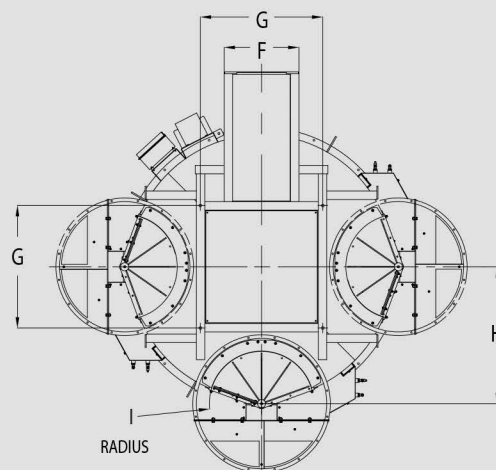

BOTTOM VIEW

|   | TURBIN MIXER MODEL           | 1700      | 3400       | 5100       | 6800       | 10,000     | 12,000     | 13,000     | 14,000     |
|---|------------------------------|-----------|------------|------------|------------|------------|------------|------------|------------|
| A | OVERALL WIDTH                | 5'-9"     | 8'-5"      | 8'-5"      | 9'-8"      | 11'-5"     | 11'-5"     | 11'-5"     | 11'-5"     |
| B | OVERALL LENGTH               | 9'-6"     | 12'-7"     | 12'-7"     | 13'-10"    | 16'-6"     | 16'-6"     | 16'-6"     | 16'-6"     |
| C | CHARGING HEIGHT              | 3'-1"     | 3'-4"      | 3'-4"      | 3'-11"     | 4'-7"      | 4'-7"      | 4'-7"      | 5'-5"      |
| D | CENTER TO OUTSIDE OF MOTOR   | 4'-8"     | 6'-0"      | 6'-0"      | 6'-9"      | 8'-9"      | 8'-9"      | 8'-9"      | 8'-9"      |
| E | CENTER TO OUTSIDE DOOR GUARD | 4'-9"     | 6'-7"      | 6'-7"      | 7'-1"      | 8'-5"      | 8'-5"      | 8'-5"      | 8'-5"      |
| F | MOTOR BASE WIDTH             | 2'-0"     | 2'-2"      | 2'-2"      | 2'-7"      | 3'-0"      | 3'-0"      | 3'-0"      | 3'-0"      |
| G | MOUNTING BOLT SPACING        | 2'-11"    | 3'-7"      | 3'-7"      | 4'-3"      | 5'-7"      | 5'-7"      | 5'-7"      | 5'-7"      |
| H | MIXER CENTER TO DOOR PIVOT   | 2'-11"    | 4'-2"      | 4'-2"      | 4'-9"      | 5'-8"      | 5'-8"      | 5'-8"      | 5'-8"      |
| I | DOOR OPENING RADIUS          | 1'-3"     | 1'-10"     | 1'-10"     | 1'-10"     | 2'-4"      | 2'-4"      | 2'-4"      | 2'-4"      |
|   | EMPTY MIXER WEIGHT           | 5,500 LBS | 10,000 LBS | 10,000 LBS | 14,000 LBS | 16,000 LBS | 18,000 LBS | 18,500 LBS | 19,500 LBS |

|  | TURBIN MIXER MODEL                    | 1700  | 3400   | 5100   | 6800   | 10,000 | 12,000 | 13,000 | 14,000 |
|--|---------------------------------------|-------|--------|--------|--------|--------|--------|--------|--------|
|  | MAXIMUM FILLING CAPACITY — POUNDS     | 1,700 | 3,400  | 5,100  | 6,800  | 10,000 | 12,100 | 13,000 | 14,000 |
|  | MINIMUM FILLING CAPACITY — CUBIC FEET | 4     | 10     | 10     | 13     | 20     | 20     | 20     | 20     |
|  | MAXIMUM FILLING CAPACITY — CUBIC FEET | 20    | 40     | 60     | 80     | 120    | 140    | 150    | 160    |
|  | DRIVE MOTOR — HORSEPOWER              | 20    | 40     | 50     | 75     | 100    | 125    | 150    | 200    |
|  | EMPTY MIXER WEIGHT — LBS              | 5,500 | 10,000 | 10,500 | 14,000 | 16,000 | 18,000 | 18,500 | 18,500 |

NOTE: CAPACITY BASED ON GLASS MATERIAL WEIGHING 85 LBS/CU FT

## MADE IN THE USA FOR YOUR WORLD

Mixer Systems, the parent corporation of GlassMaster, has been manufacturing equipment for the concrete products and other related industries since 1979. Today, our systems are at work in some 60 countries around the world. An 86,000 square-foot facility houses complete design and fabrication capabilities. Our product line is the largest in the industry, built with American reliability to stand up to the challenges of your world.



All under one roof at Mixer Systems headquarters: Design, engineering, manufacturing and a \$3 million parts inventory.

**GLASSMASTER®**

190 Simmons Avenue  
P.O. Box 10  
Pewaukee, WI 53072

info@glassmaster.com  
262-691-3100 | mixersystems.com  
1-800-756-4937 Toll Free in USA

GM 250 091523. Printed in USA.  
© GlassMASTER

**MIX**  
Mixer Systems, Inc.®